

Located in the heart of Laval Center industrial park with easy access to all major highways.

Building characteristics

LAND AREA	141,754 ft ²
YEAR OF RENOVATION	2002
YEAR OF CONSTRUCTION	1981
NUMBER OF FLOORS	2
SPRINKLERS	Yes

BUILDING ACCESSIBILITY

OUTDOOR PARKING	145
ROAD ACCESS	Highway 440 and Industrial Boulevard
BUS	37
TRAIN STATION	Vimont Station

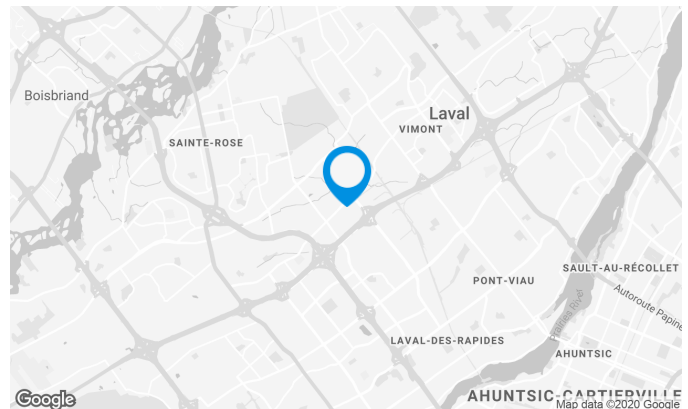

Owen Paek

LEASE AGENT
LEASING - INDUSTRIAL, MONTREAL AREA

T 514 737-3344 #3257

C 514 709-3830

E OWEN.PAEK@COMINAR.COM

Superficie locative disponible de 2,700 ft²

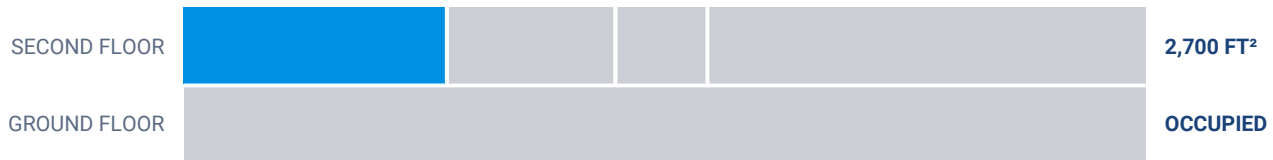

List of available offices

SUITE	FLOOR	AVAILABILITY	AREA
Suite #1474	2		945 ft ²
Suite #1451	2		1,730 ft ²
Suite #1523	2	Immediate	2,700 ft ²

1415 to 1531 Berlier Street, Laval, QC, H7L 3Z1



RDC PLAN

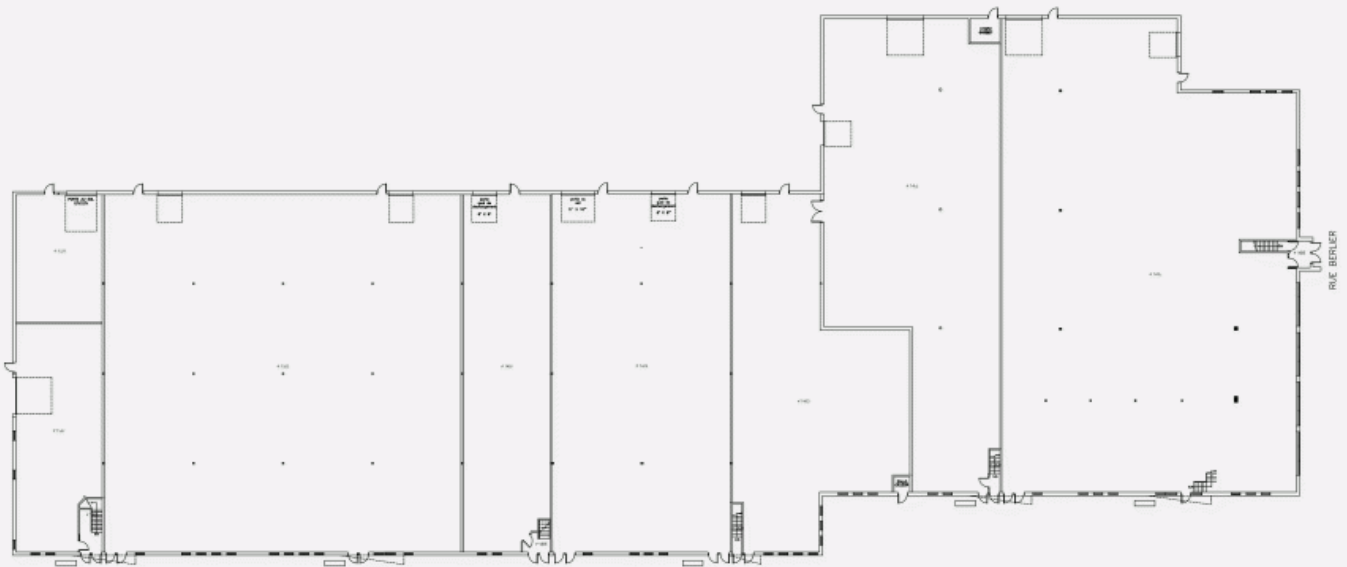

SECOND FLOOR PLAN

