

Located along the Félix-Leclerc Highway at the intersection of the Robert-Bourassa Highway (Métrobec). Neighbor of Lebourgneuf district.

## Building characteristics

TOTAL LEASING AREA	128,982 ft <sup>2</sup>
YEAR OF CONSTRUCTION	1987
NUMBER OF FLOORS	2
% COMMON AREA	5
OPTICAL FIBER	Yes
SPRINKLERS	Yes
SECURITY	Access cards

## BUILDING ACCESSIBILITY

OUTDOOR PARKING	355
ROAD ACCESS	Félix-Leclerc Highway / Robert-Bourassa Highway / Henri IV Highway

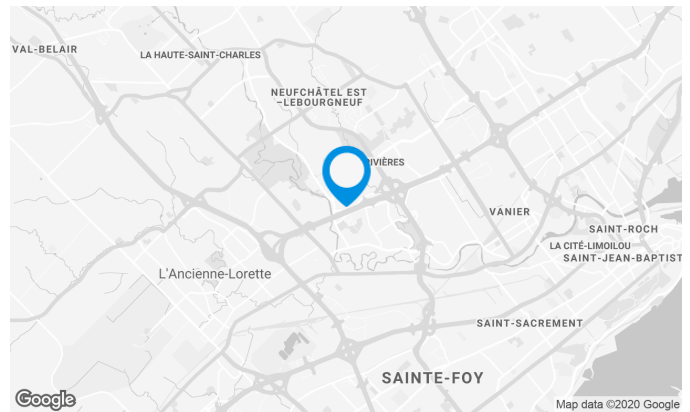

Available leasing areas from 211 ft<sup>2</sup> to 2,417 ft<sup>2</sup>

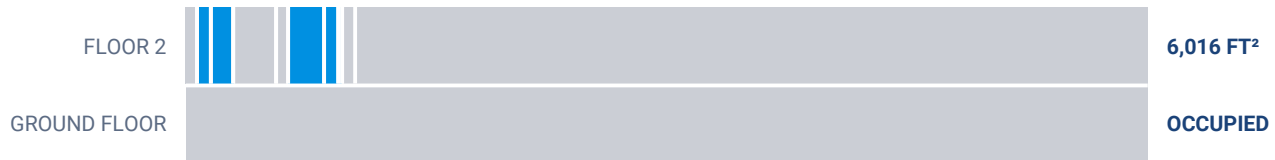

List of available offices

SUITE	FLOOR	AVAILABILITY	AREA
Suite #480	2	Immediate	211 ft <sup>2</sup>
Suite #470	2	Immediate	953 ft <sup>2</sup>
Suite #300	2	Immediate	2,417 ft <sup>2</sup>
Suite #270	2		806 ft <sup>2</sup>
Suite #260	2		2,884 ft <sup>2</sup>
Suite #250	2		874 ft <sup>2</sup>
Suite #202	2		747 ft <sup>2</sup>
Suite #205	2	Immediate	933 ft <sup>2</sup>
Suite #208	2	Immediate	1,502 ft <sup>2</sup>



RDC PLAN

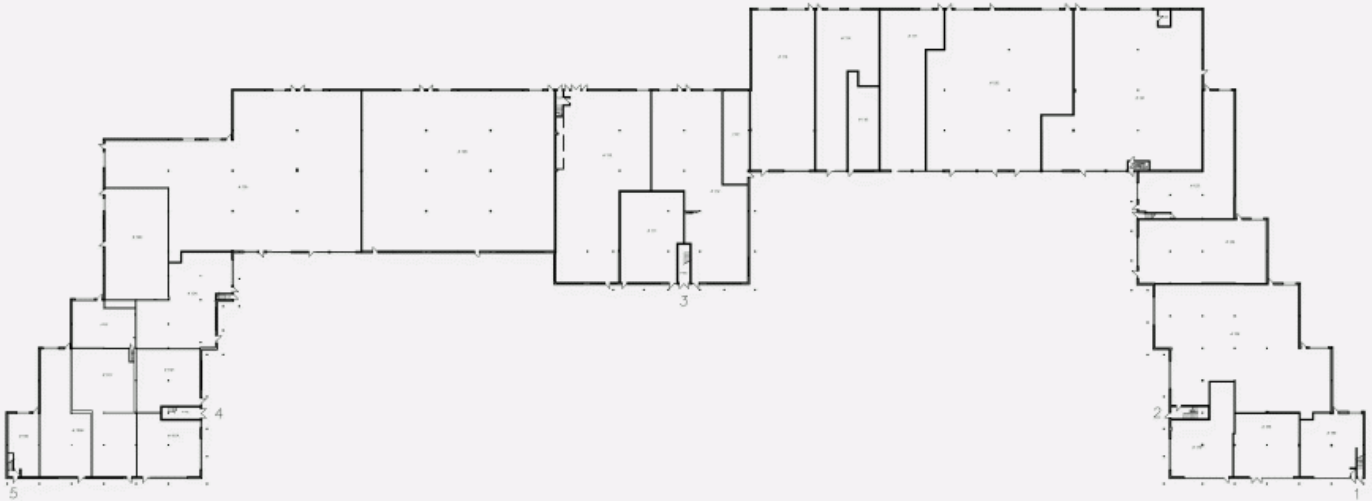

RUE JEAN-PERRIN

FLOOR 2 PLAN

