

35 de Lauzon Street, Boucherville, QC, J4B 1E7

Suite #3

Building characteristics

LAND AREA	101,329 ft ²
AVAILABILITY	30 jours
YEAR OF CONSTRUCTION	1990
NUMBER OF FLOORS	1
SPRINKLERS	Yes



BUILDING ACCESSIBILITY

PARKING - OUTDOOR	90
ROAD ACCESS	Highways 20 and 25

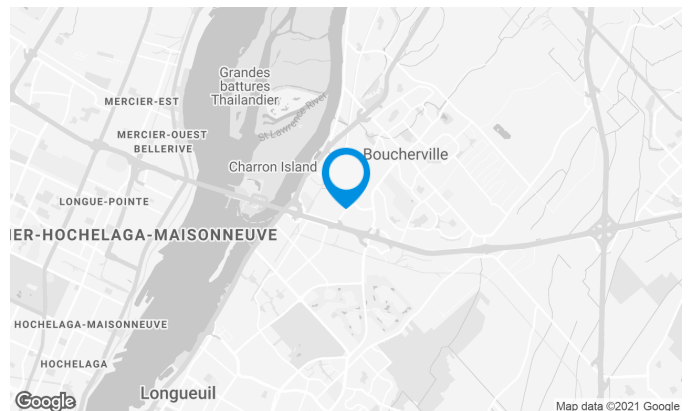

Stéphane Robidas

LEASING DIRECTOR
LEASING - INDUSTRIAL, MONTREAL AREA

T 514 737-3344 #3373

C 514 605-5152

E STEPHANE.ROBIDAS@COMINAR.COM

Space characteristics

NUMBER OF FLOORS	1
HEIGHT	20'
SHIPPING	1 truck level 1 drive-in
ADDITIONNAL RENT	\$4.42 /ft ²
SPACE BETWEEN THE COLUMNS	19' x 25'

AVAILABLE LEASING AREA: 7,500 FT²

WAREHOUSE	6,300 ft ²
OFFICES	1,200 ft ²
AVAILABILITY	30 jours

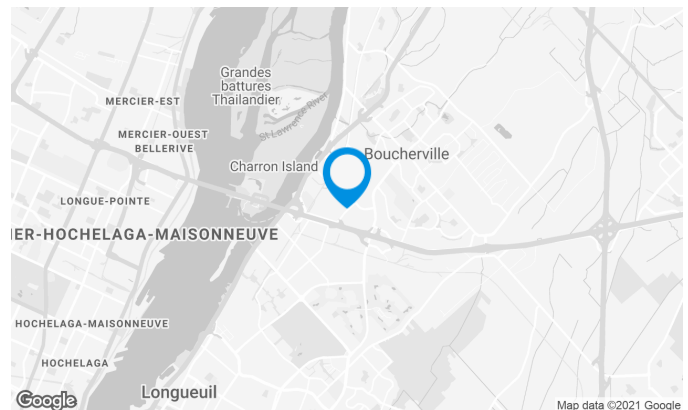
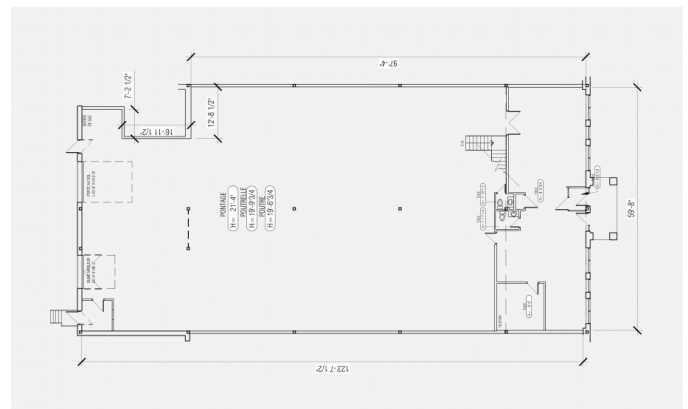
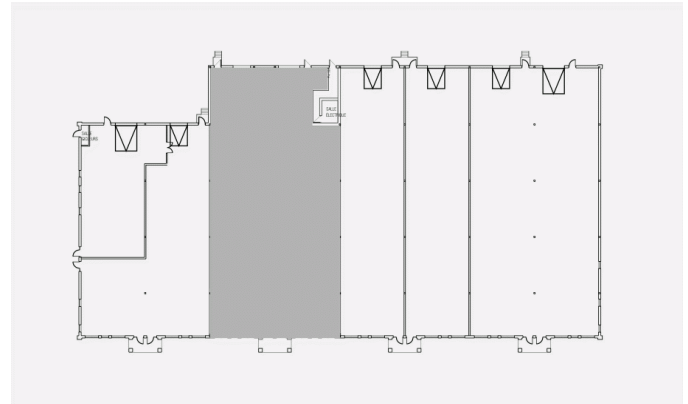

Stéphane Robidas

LEASING DIRECTOR
LEASING - INDUSTRIAL, MONTREAL AREA

T 514 737-3344 #3373
C 514 605-5152
E STEPHANE.ROBIDAS@COMINAR.COM

LOCATION PLAN

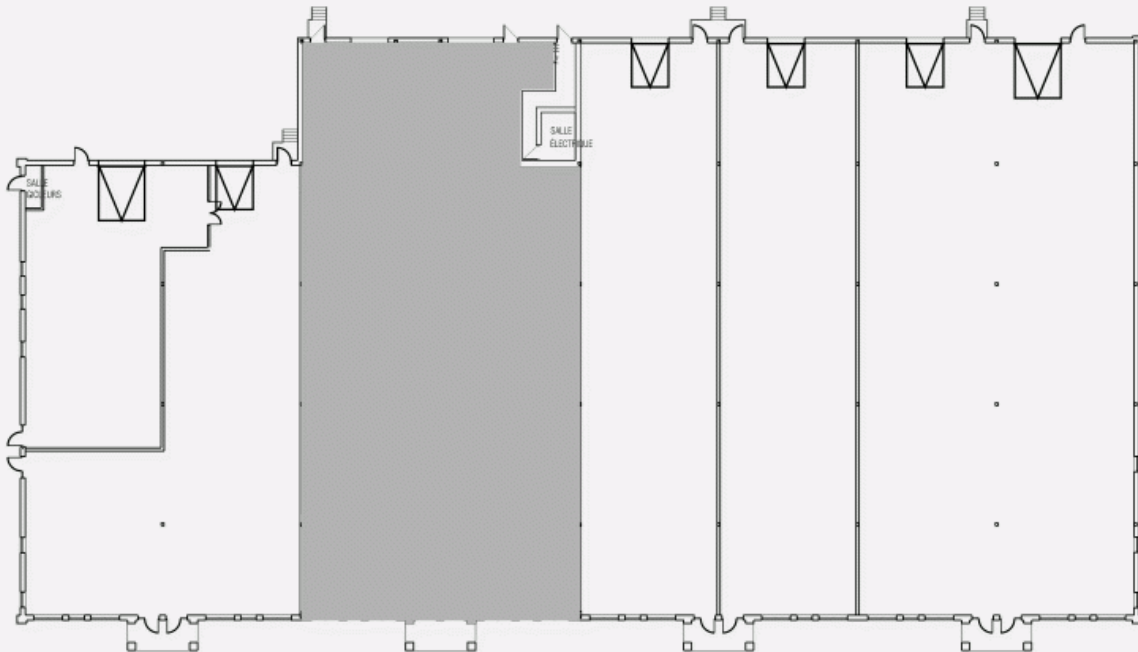

LAYOUT PLAN

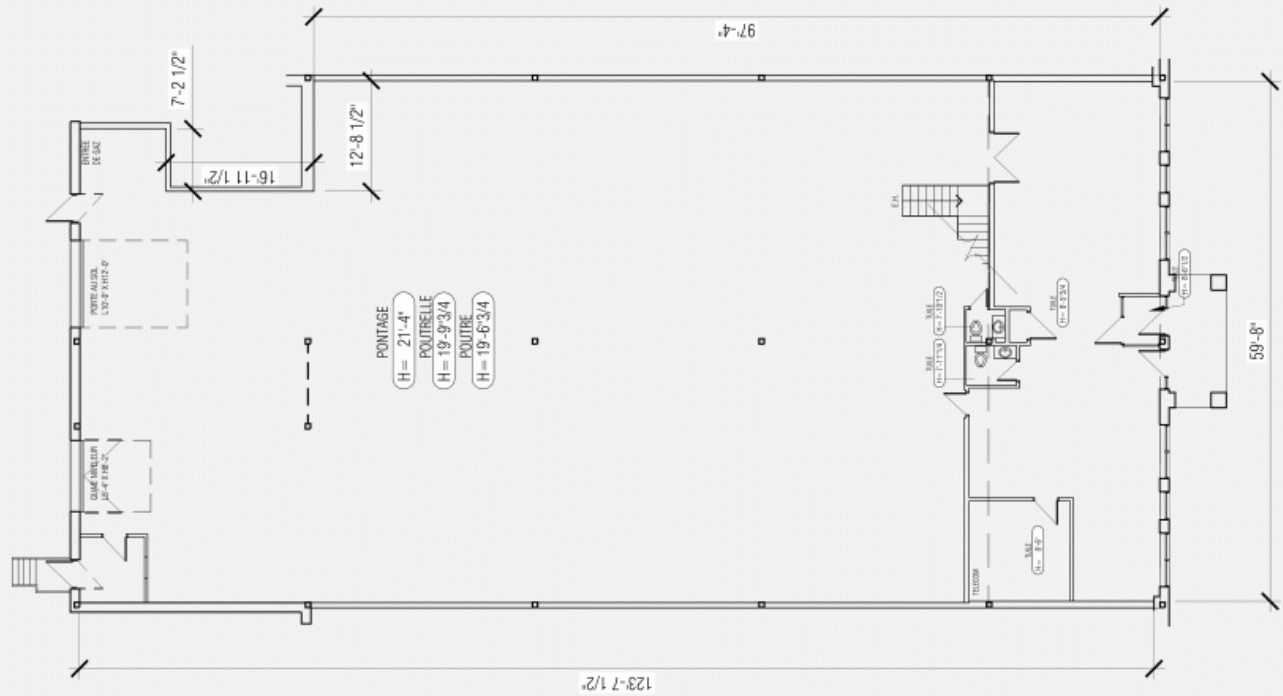

PLAN MEZZANINE

