

1041 Pierre-Bertrand Boulevard, Quebec, QC, G1M 2E8

Suite #100

Located on the commercial artery of the Pierre Bertrand boulevard near autoroute Félix-Leclerc. Neighboring Lebourgneuf.

Building characteristics

BUILDING AREA	115,218 ft ²
LAND AREA	1,000,000 ft ²
AVAILABILITY	April 2022
NUMBER OF FLOORS	1
SPRINKLERS	Yes

BUILDING ACCESSIBILITY

PARKING - OUTDOOR	235
ROAD ACCESS	Located on the commercial artery of Pierre-Bertrand Boulevard. Neighbor of the district Lebourgneuf
BUS	64, 65, 82, 82A, 185, 982

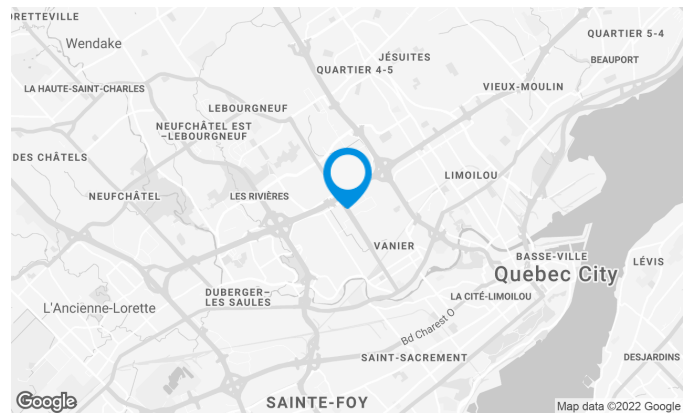

Location Cominar



T 418 681-6300 #2411
E LOCATIONQUEBEC@COMINAR.COM

Space availability to be confirmed.

Space characteristics

NUMBER OF FLOORS	1
HEIGHT	0'
SHIPPING	13 truck levels

AVAILABLE LEASING AREA: 23,947 FT²

OFFICES	23,947 ft²
AVAILABILITY	April 2022

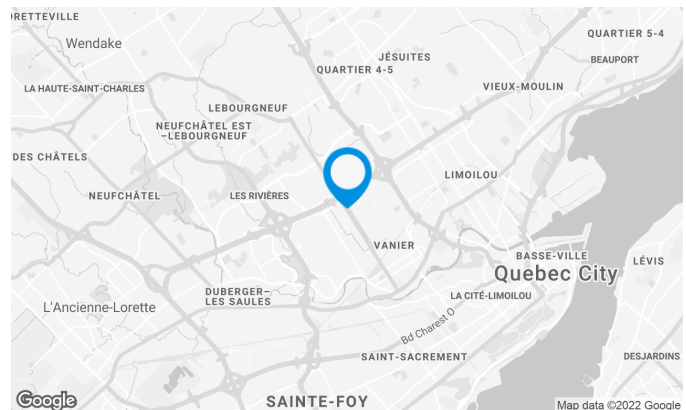
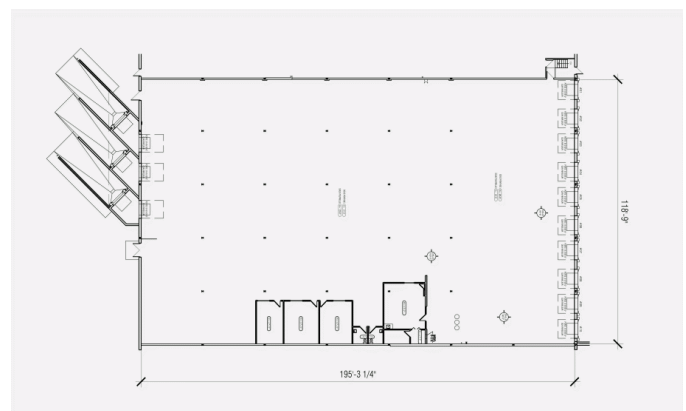
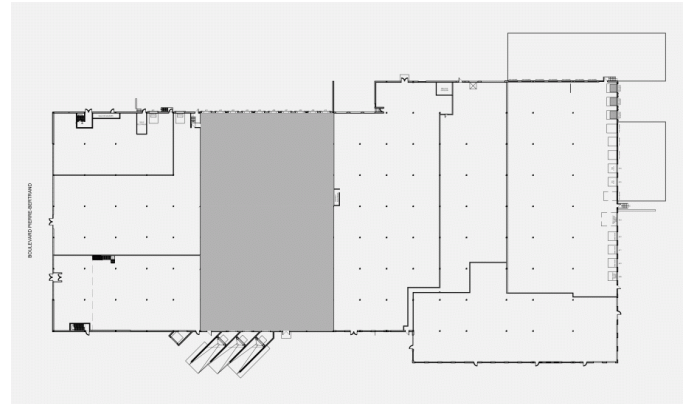

Location Cominar



T 418 681-6300 #2411
E LOCATIONQUEBEC@COMINAR.COM

LOCATION PLAN

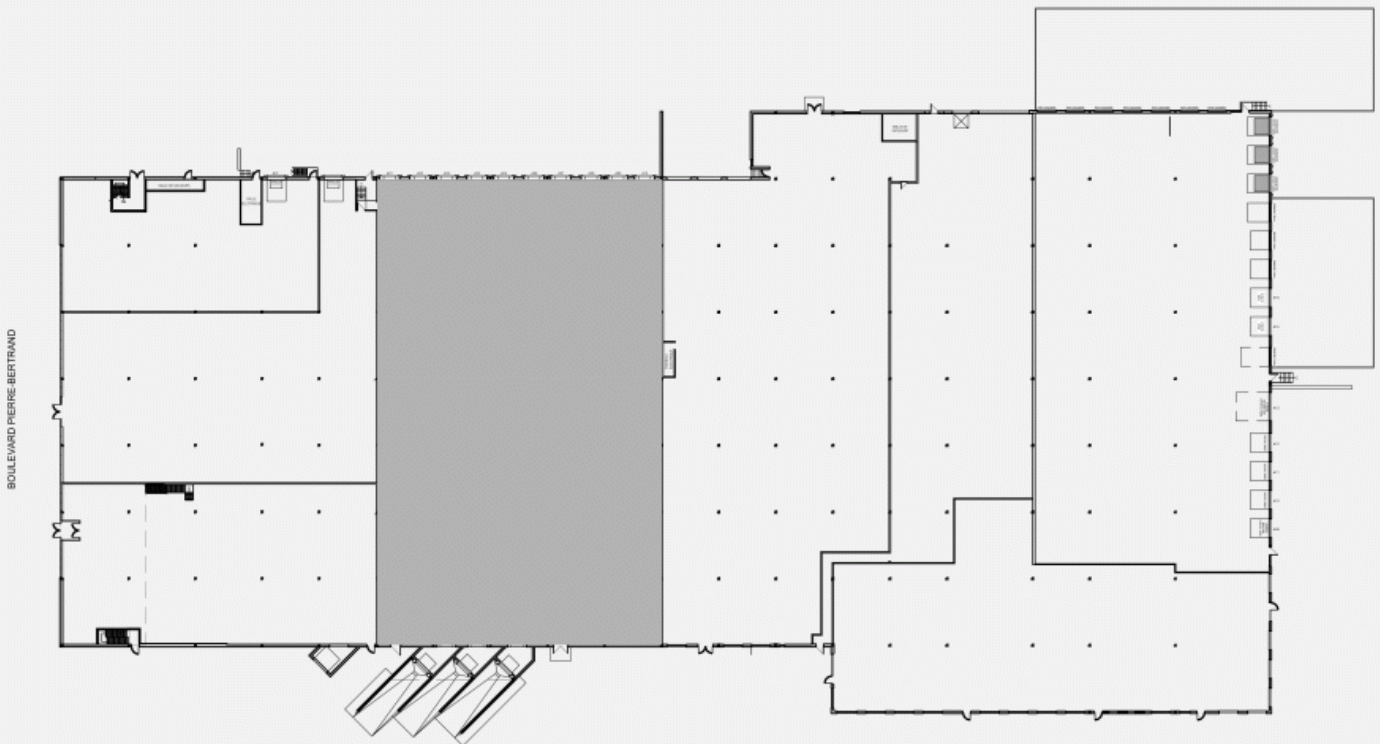

LAYOUT PLAN

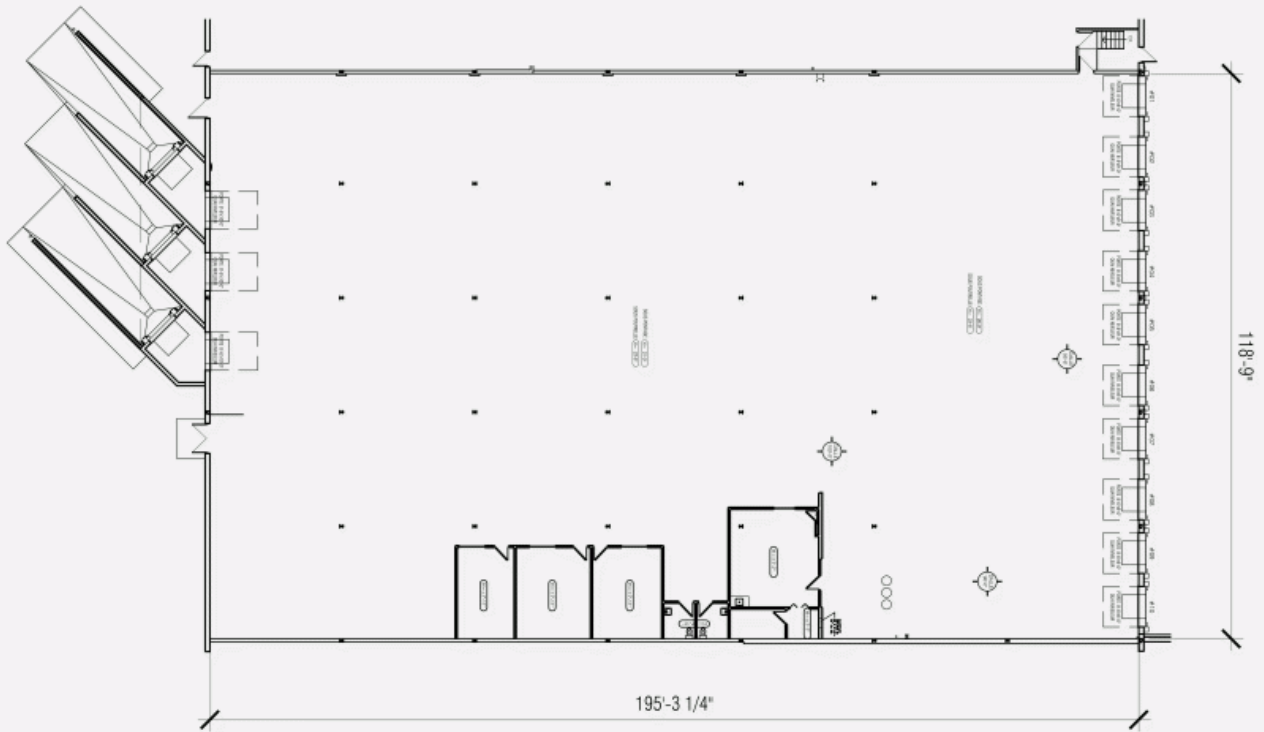

1041 Pierre-Bertrand Boulevard, Quebec, QC, G1M 2E8
Suite #100

