

# Place du Commerce

## Place du Commerce Street, Brossard, QC

Place du Commerce is a new format community retail development located at 1-3 Place du Commerce, in the City of Brossard. Strategically located in Brossard, in front of Champlain Mall, just minutes away from Champlain Bridge and the main streets of the South Shore.

With the 200,000 daily average car traffic located on the intersection of Highway 10 and Taschereau Boulevard, Mail Champlain is located in the heart of the busiest and most thriving commercial area on the South Shore of Montreal.

### Building characteristics

STORE LEASING AREA	43,192 sq. ft.
OUTDOOR PARKING	240
BUS	Terminus Panama station a block away and future SLR station

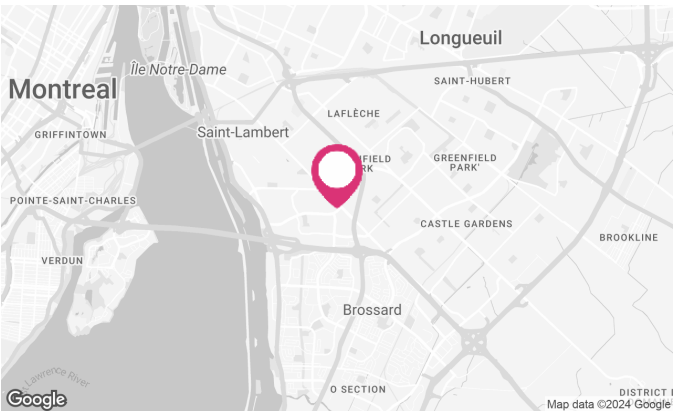

Place du Commerce  
Place du Commerce Street, Brossard, QC

Sociodemographic profile

RETAIL AREA	PRIMARY	SECONDARY	SECONDARY A
AVERAGE AGE	42.4	41.6	40.3
GENDER (%)	70F 30M	70F 30M	70F 30M
LANGUAGE (%)	0 Fr	0 Fr	0 Fr
NUMBER OF HOUSEHOLDS	N/A	N/A	N/A
AVERAGE HOUSEHOLD SIZE	2.3	2.3	2.0
AVERAGE HOUSEHOLD INCOME (\$)	76,667	79,533	72,414
POPULATION	96,775	197,869	660,847
2020 PROJECTED POPULATION	101,326	208,287	701,724
2026 PROJECTED POPULATION	105,364	217,300	736,173

## Place du Commerce

Place du Commerce Street, Brossard, QC



Place du Commerce  
Place du Commerce Street, Brossard, QC

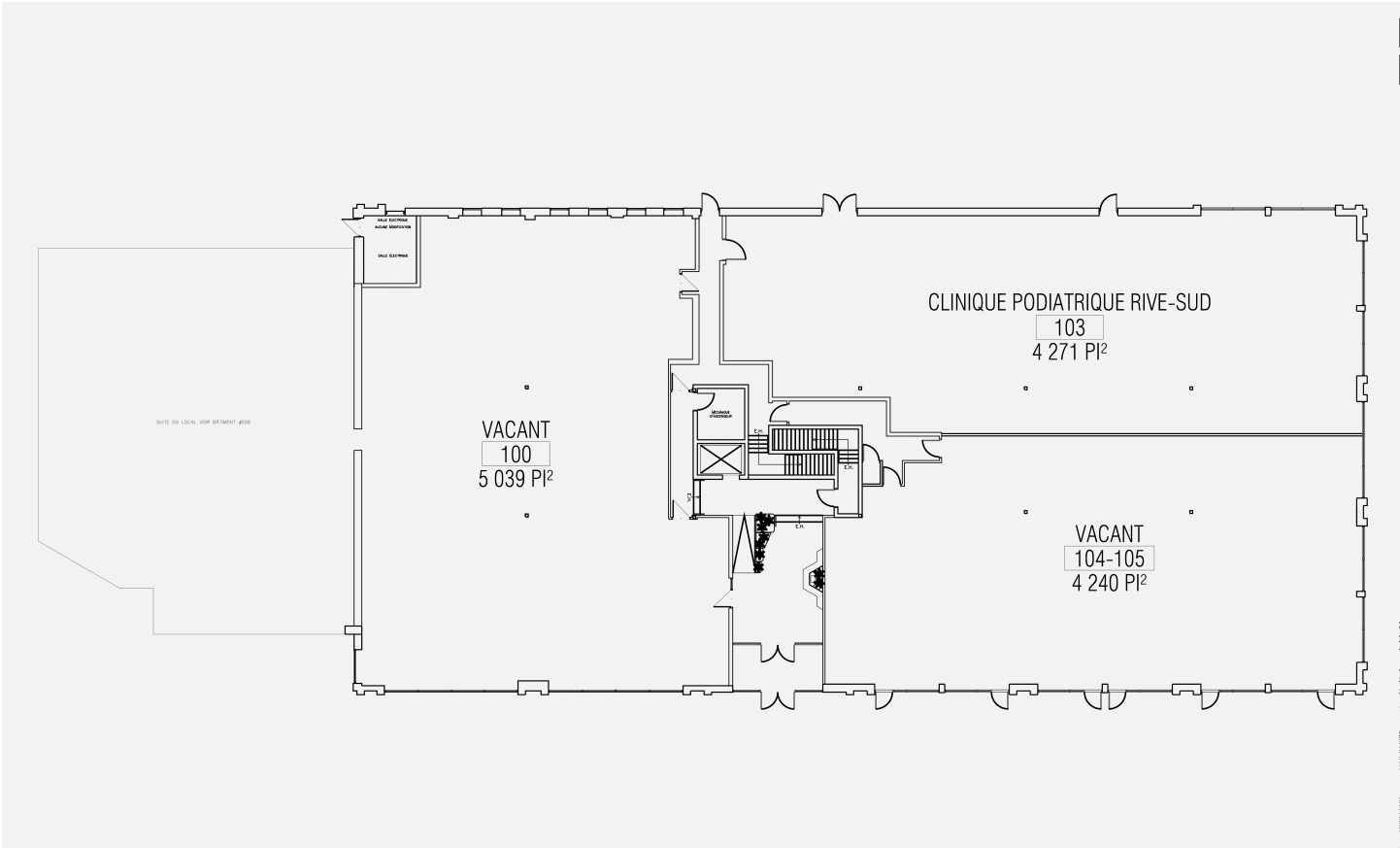

Place du Commerce  
Place du Commerce Street, Brossard, QC

